

7 Inch 16x2 LCD Display Module Character 1602 STN Blue Background White Backlight

Our Product Introduction

Basic Information

- Place of Origin: China
- Brand Name: BBI
- Certification: ISO90001 RoHS
- Model Number: BBI-001
- Minimum Order Quantity: 1000
- Price: 0.7-7USD
- Packaging Details: CARTON
- Delivery Time: 3-47WEEKS
- Payment Terms: T/T
- Supply Ability: 100000/MONTH

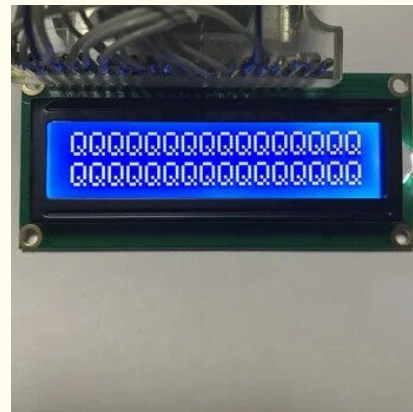

Product Specification

- Name: 1602 LCD Display Module
- Photo Format: JPG,PNG,BMP
- Screen Size: 7 Inches
- Operating Temperature: -20~+70 °C
- Display Type: STN/ BLUE, Negative, Transmissive
- Driving Method: 1/16Duty, 1/5 Bias
- Active Display Area: 56.21(W)*11.5(H) Mm
- Highlight: **16x2 LCD Display Module, 1602 LCD Display Module, 7 Inch LCD Display Module**



for more products please visit us on lcdftscreen.com

7 Inch 16x2 LCD Display Module Character 1602 STN Blue Background White Backlight k@smartwinlcd.cn lcdtftscreen.com
 j'an, Dongguan, Guangdong, China 523881

Product Description

- (1) **Display Type:** STN/BLUE, Negative, Transmissive
- (2) **Display Mode:** 16 characters x 2 lines
- (3) **Backlight Type:** White LEDs, Side
- (4) **Driving Method:** 1/16 Duty, 1/5 Bias, 3.3V
- (5) **Interface:** 4-bits or 8-bits interface
- (6) **Viewing Angle:** 6 O'clock

Structure	LCD + IC + ZEBRA + BL + PCB
PCB Size	80(L)*36(W)*11(D) mm
Viewing Area	66(W)*17(H) mm
Active Area	56.21(W)*11.5(H) mm
Dot Size	0.56(W)*0.56(H) mm
Operating Temperature	-20~+70 °C
Storage Temperature	-30~+80 °C

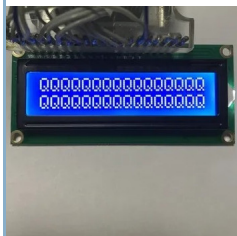

Packaging & Shipping:

Packaging: Carton boxes, Cupboard , EPE, Blister Tray, About the package way, it is up to the size of products, according to customer request and demand. Different countries have not same requirement..

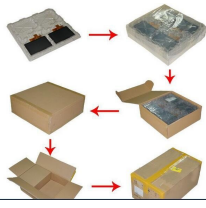

Shipping: Express way as DHL, Fedex, EMS, UPS, air shipping, sea shipping, Any shipping method you prefer.

2-7days	2-5days	2-7days	3-10days	2-5days	2-7days

Notice

1. DDC for South Korea and Remote areas.
2. DDC for Hong Kong, Taiwan, South Korea, Japan, Thailand, Singapore and Malaysia.
3. Heavy type product can't be sent by EMS.
4. The final order is sent by EMS, please refer to the DMS / DPM issue!

Payment Method:



FAQ:

1. I want the LCD display 8 digits and the outline size is 65x30x2.8mm.....?

Answer: No problem. Firstly, please kindly send us your specification/ drawing paper
 If you have not the specification, you can also provide your samples; we will recommend the suitable one if it is standard products.

Or we can customize for you based on your own requirement.

2. This LCD is just what we want, but it is big size, do you have any smaller size? And the display content need to be changed a little.

Answer: For the segment type LCD module, if you need modify the outline size or display content, a new LCD glass module is need. We have to open new tooling for you.

3. This LCD display is HTN type, but I want STN type, can you make?

Answer: That's all right . we can change for you as per you request.

4. I want customize a new LCD module. Can you do?

Answer: Yes, we can. Please send your drawing paper. If you have not, please advise me the outline size of the LCD display, display information(Glass thickness, Polarizer, Display Type, Connector mode, Storage Temp. Operating Temp. Supply Voltage, Viewing direction, drive condition), we can customize for you.

5. What is leading time for tooling?

Answer: General speaking, it will cost 15 to 25 days after drawing paper confirmation and tooling charge payment, we can report you the exact time when you confirm the drawing paper.

8 D - C C 20 04 B	7 0 0 X 4 7 0	6 0 2 X 2 2 0	0 4 2 X 0 4 6	2 3 4 X 0 3	1/ 16 0	S6A 007 0	C O B	Y Y
8 D - C C 20 04 C	1 4 6 0 X 6 2 5 0	1 2 3 5 X 4 1 3 1 0	0 9 2 X 1 1 2	4 8 4 X 9 1 2	1/ 16 9	S6A 006 9	C O B	Y Y
8 D - C C 24 02 A	1 8 5 X 3 6 0	9 3 5 X 1 6 5 0	0 6 X 0 6 5 5	3 2 X 5 5 5	1/ 16 9	S6A 006 9	C O B	Y Y
8 D - C C 24 02 B	2 0 8 0 X 4 2 0 0	1 7 8 0 X 2 1 3 0	1 1 6 X 1 6 6	6 0 X 9 6 3	1/ 16 9	S6A 006 9	C O B	Y Y
8 D - C C 40 01 A	1 8 2 X 1 3 3 5 5	1 5 4 X 1 7 6 5 5	0 4 X 0 6 5 5	3 2 X 6 3 5	1/ 16 9	S6A 006 9	C O B	Y Y
8 D - C C 40 02 B	1 8 2 X 3 3 5 5	1 5 4 X 1 6 5 5	0 4 X 0 6 5 5	3 2 X 5 5	1/ 16 9	S6A 006 9	C O B	Y Y
8 D C C 40 04 A	9 0 0 X 5 4 9 0	4 7 0 X 2 9 5 0	0 X 5 8 9	7 8 X 4 8 9	1/ 16 9	S6A 006 9	C O B	Y Y
8 D - G 12 23 2A	1 2 X 4 4 0	4 X 1 8 4 5	0 4 X 0 4 4	4 X 0 4 4 4	1/ 32 20	SE D15 20	C O B	Y Y
8 D - G 12 23 2B	1 2 X 3 6 0	0 5 3 1 8 4 5 1	0 6 X 1 0 4 5	4 X 0 4 4 5	1/ 32 20	SE D15 20	C O B	Y Y
8 D - G 12 23 2C	1 2 X 6 0 2 2	9 8 0 X 2 0 2	7 6 X 0 5 6 1	0 3 X 0 6 6 5	1/ 32 20	SE D15 20	C O B	Y Y
8 D - G 12 23 2D	1 2 X 4 7 2 4	0 6 X 2 5 6 1	0 3 X 0 6 6 5	4 X 0 4 4 5	1/ 32 20	SE D15 20	C O B	Y Y

8 D - G 12 86 44	1 2 8 X 7 6 4 0	7 8. 0 X 4 0. 4. 5 6 0	6 2. 3 X 4 0. 5 6 0	0. 9 X X 0. 6 0	4 4 X X 0. 6 0	1/ 64	S6B 010 8A	C O B	Y Y
8 D - G 12 86 44	1 2 8 X 6 4 0	1 0 5. 0 8 0 0 5	7 2. 4 X 4 0. 4 8 2	0. 8 X X 0. 5 2	0. 2 X X 0. 5 2	1/ 64	S6B 010 8A	C O B	Y Y
8 D - G 12 86 44	1 2 8 X 7 6 4 0	9 3. 2. 0 8 2 0 0	7 2. 4 X 4 0. 4 8 2	0. 8 X X 0. 5 2	0. 2 X X 0. 5 2	1/ 64	S6B 010 8A	C O B	Y Y
8 D - G 12 86 44	1 2 3. 0 8 2 0 0	1 7 2. 4 8 2 0 0	0. 8 X X 0. 5 2	0. 2 X X 0. 5 2	0. 2 X X 0. 5 2	1/ 64	S6B 010 8A	C O B	Y Y
8 D - G 12 86 44	1 2 8 X 7 6 4 0	9 3. 2. 0 8 2 0 0	7 2. 4 X 4 0. 4 8 2	0. 8 X X 0. 5 2	0. 2 X X 0. 5 2	1/ 64	ST7 920	C O B	Y Y
8 D - G 19 26 44	1 3 9 0 0 X 6 5. 9. 6 1 0	1 0 4. 6 1 1 0 0	0. 5 X X 0. 5 1	0. 1 X X 0. 5 1	0. 1 X X 0. 5 1	1/ 64	S6B 010 8A	C O B	Y Y
8 D - G 19 26 44	1 2 9 0 0 X 6 3 4 2. 9. 6 1 0	1 0 4. 6 1 1 0 0	0. 5 X X 0. 5 1	0. 1 X X 0. 5 1	0. 1 X X 0. 5 1	1/ 64	S6B 010 8A	C O B	Y Y
8 D - G 24 06 44	1 4 0. 0 0 X 6 3 5. 9. 3 9 0	1 3 5 4 2. 3 9 0. 0. 3 9	0. 4 X X 0. 5 9	0. 1 X X 0. 5 9	0. 1 X X 0. 5 9	1/ 64	T69 63C	Q F P / C O B	Y Y
8 D - G 24 01 28 8A	1 4 4 4 X X 1 2 0 4	1 1 4 5 X X 0. 0 4 5	0. 4 X X 0. 4 5	0. 1 X X 0. 4 5	0. 1 X X 0. 4 5	1/ 12	T69 63C	Q F P / C O B	Y Y