

## 1.54 Inch TFT LCD Screen with 240x240 Dots Resolution, SPI Interface, and ST7789 Driver for High-Quality Display

Our Product Introduction

### Basic Information

- Place of Origin: China
- Brand Name: BBI
- Certification: ISO90001 RoHS
- Minimum Order Quantity: 1000
- Price: 0.7-7USD
- Packaging Details: CARTON
- Delivery Time: 3-47WEEKS
- Payment Terms: T/T
- Supply Ability: 100000/MONTH



### Product Specification

- Active Area: 27.72(H)\*27.72(V) Mm
- Peration Temperature: -20 +70
- Type: LCD
- View Direction: All
- Color: Full Color
- Color Configuration: R.G.B. Vertical Stripe
- Highlight: **1.54 inch TFT LCD screen,  
240x240 SPI LCD display,  
ST7789 small LCD module**

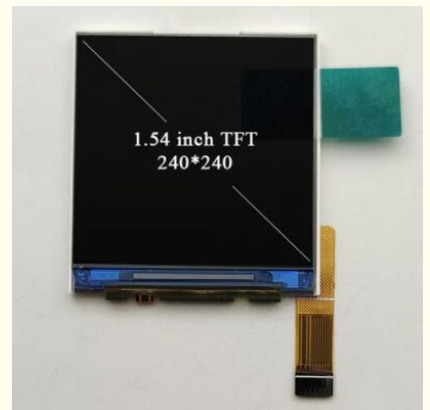

for more products please visit us on [lcdtftscreen.com](http://lcdtftscreen.com)

## Product Description

### 1.54 Inch TFT Small LCD Screen 240×240 Dots ST7789 2.8V 15pin FPC SPI

#### Product Overview

This 1.54-inch TFT small LCD display features a core configuration of 240×240 pixels, ST7789 driver, 2.8V power supply, 15-pin FPC with SPI interface. It is a high-adaptability solution for small-sized full-color displays, widely used in wearable, industrial control and embedded scenarios.

#### Technical Specifications

|                |                      |
|----------------|----------------------|
| Panel Size     | 1.54 Inch (Diagonal) |
| LCD Resolution | 240×240 Dots         |
| Viewing Angle  | All                  |
| Driver IC      | ST7789T3             |
| Interface      | SPI                  |
| FPC            | 15pin                |

#### Detailed Parameters

| Item                  | Specifications               |
|-----------------------|------------------------------|
| Product Name          | 1.54 Inch TFT LCD            |
| LCD Type              | IPS                          |
| Resolution            | 240×240 dots                 |
| Operating Temperature | -20°C to +70°C               |
| Storage Temperature   | -30°C to +80°C               |
| FPC Connector         | 15PIN, ZIF type              |
| Driver IC (COG)       | ST7789T3                     |
| Interface             | SPI                          |
| Backlight Type        | 3-LED, White                 |
| Luminance             | 250 cd/m <sup>2</sup>        |
| Outline Dimension     | 31.52(H)×33.72(V)×1.92(D) mm |
| Active Area           | 27.72(H)×27.72(V) mm         |

#### Core Features

**Compact High-Quality Display:** 240×240 pixel density ensures clear text and graphics with IPS full-view display and no blind spots

**Easy Integration:** SPI interface requires fewer connections with fast transmission; 15-pin FPC is flexible and suitable for narrow spaces

**Low Power Consumption:** 2.8V low voltage with LED backlight design, ideal for battery-powered applications

**High Compatibility:** Mature ST7789 driver with rich open-source libraries supports rapid prototyping

#### Typical Applications

Smart wearables: Smartwatches, fitness trackers, displaying time, heart rate, and exercise data

Portable medical devices: Blood glucose/saturation meters, portable ultrasound, ECG monitors

Embedded and industrial control: Small PLCs, sensor nodes, smart home panels, robot status screens

Consumer electronics and DIY: MP3/MP4 players, miniature game consoles, Bluetooth speakers, electronic price tags

Vehicle-mounted and IoT: Tire pressure monitoring screens, GPS locators, IoT gateway displays

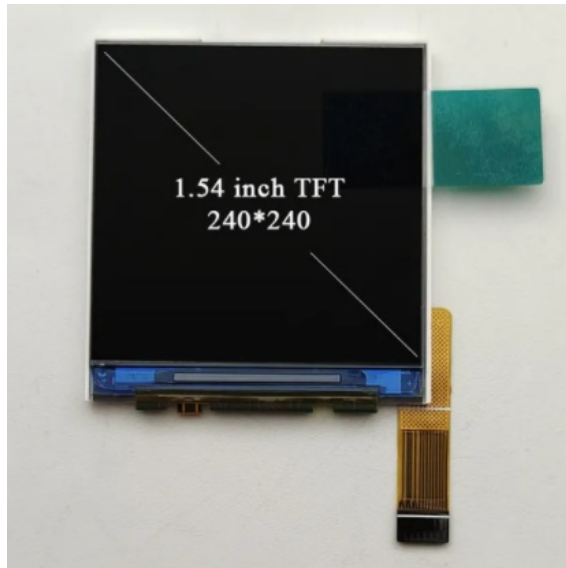

1.5寸

1.6寸



### Packaging & Shipping

**Packaging:** Carton boxes, Cupboard, EPE, Blister Tray. Packaging method depends on product size and customer requirements.

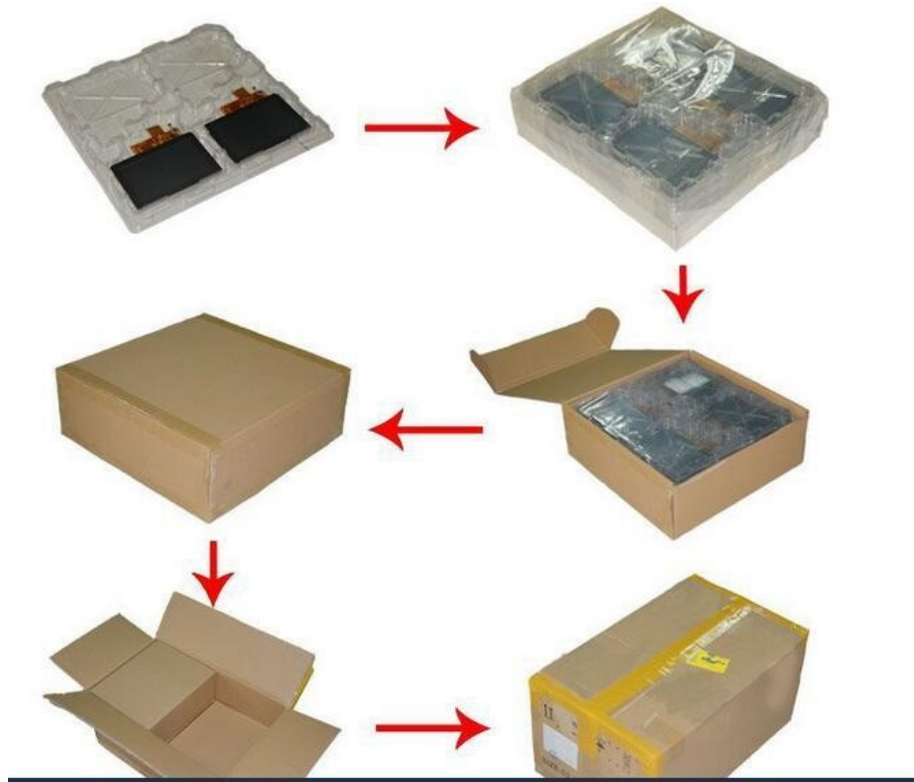

**Shipping:** Express services including DHL, Fedex, EMS, UPS, air shipping, and sea shipping available.

|                                                                                     |                                                                                                                                                                                                                                                                                                                          |                                                                                     |                                                                                     |                                                                                      |                                                                                       |                                                                                       |
|-------------------------------------------------------------------------------------|--------------------------------------------------------------------------------------------------------------------------------------------------------------------------------------------------------------------------------------------------------------------------------------------------------------------------|-------------------------------------------------------------------------------------|-------------------------------------------------------------------------------------|--------------------------------------------------------------------------------------|---------------------------------------------------------------------------------------|---------------------------------------------------------------------------------------|
|  |                                                                                                                                                                                                                                       |  |  |  |  |  |
|                                                                                     | 2-7days                                                                                                                                                                                                                                                                                                                  | 2-8days                                                                             | 2-7days                                                                             | 3-15days                                                                             | 2-5days                                                                               | 2-7days                                                                               |
| <b>Notice</b>                                                                       | <ol style="list-style-type: none"> <li>EMS for Brazil, Russia and Remote areas .</li> <li>SF for Hong Kong, Taiwan, South Korea, Japan, Thailand, Singapore and Malaysia .</li> <li>Having logo product can't be sent by FEDEX .</li> <li>The Brazil want to use FEDEX/DHL , need to offer CNPJ / CPF to us !</li> </ol> |                                                                                     |                                                                                     |                                                                                      |                                                                                       |                                                                                       |

#### Payment Methods



#### Frequently Asked Questions

**Q: I want the LCD display 8 digits and the outline size is 65x30x2.8mm?**

A: Please send us your specification or drawing. If you don't have specifications, provide samples and we'll recommend suitable products or customize based on your requirements.

**Q: This LCD is just what we want, but it's too big. Do you have smaller sizes?**

A: For segment type LCD modules requiring size or display content modifications, new tooling is required.

**Q: This LCD display is HTN type, but I want STN type. Can you make it?**

A: Yes, we can modify according to your specifications.

**Q: I want to customize a new LCD module. Can you do it?**

A: Yes, we can customize. Please provide your drawing or specifications including outline size, display information, glass thickness, polarizer, display type, connector mode, temperature ranges, supply voltage, viewing direction, and drive conditions.

**Q: What is the lead time for tooling?**

A: Typically 15 to 25 days after drawing confirmation and tooling charge payment.

**Q: Can you send us samples for checking?**

A: Yes, sample orders are available.

**Q: What is the lead time?**

A: For standard products in stock, lead time is one day after payment. For mass production of special products, lead time is approximately 15-30 days.

---

## Our Services

- Free repair within one year after shipment
- Replacement within 30 days for product-related issues
- Custom logo printing and model number application
- Competitive shipping rates through established partnerships
- Professional technical support and responsive after-sales service
- Comprehensive quality inspection and testing before shipment
- 24-hour response time for customer inquiries and support
- Full customization capabilities for all types of LCD displays

## Product Applications

**Household Appliances:** Refrigerators, air conditioners, fans, heaters, water heaters, air purifiers, washing machines, microwave ovens

**Communication Equipment:** Telephones, interphones, fax machines, wireless wifi

**Automotive Electronics:** On-board entertainment systems, navigation, audio, cameras, anti-theft devices

**Instruments:** Water meters, electric meters, multimeters, electronic scales, pressure and temperature meters

**Fitness Equipment:** Treadmills, fitness bikes, training devices, pedometers, electronic scales

**Financial:** Tax control cash machines, POS systems, banknote counting machines

**Consumer Electronics:** MP3/MP4 players, electronic dictionaries, e-readers, learning machines, calculators



**Dongguan Bibuke Electronic Technology Co., Ltd.**



+8613711912723



Jack@smartwinlcd.cn



lcdftscreen.com

Shangyu Commercial Centre Chang'an, Dongguan, Guangdong, China 523881