

1.44 Inch TFT LCD Screen with 30.05 * 33.82 mm Outline Size and 262K Colors for Smart Home Applications

Our Product Introduction

for more products please visit us on lcdtftscreen.com

Basic Information

- Place of Origin: China
- Brand Name: BBI
- Certification: ISO90001 RoHS
- Minimum Order Quantity: 1000
- Price: 0.7-7USD
- Packaging Details: CARTON
- Delivery Time: 3-47WEEKS
- Payment Terms: T/T
- Supply Ability: 100000/MONTH



Product Specification

- Screen Size: 1.44 Inches
- Viewing Angle: 12 O' Clock
- Display Type: TFT LCD
- Touch Screen: No
- Luminance: 250 Cd/m²
- Backlight: White LED
- Outline Size: 30.05 * 33.82 Mm * 2.3 T
- Screen Type: TFT
- Highlight: 1.44 Inch TFT LCD Screen,
30.05 * 33.82 mm LCD Module,
262K Colors TFT Display



Small TFT LCD Screen 1.44 Inch With MCU Interface Lcd Module For Smart Home

Product Details

Core display and size advantages: This LCD screen adopts TFT liquid crystal technology, with 262K colors meaning it can present delicate and vivid color transitions, accurately reproduce the color details of various icons and data, providing a comfortable visual experience. The 30.05*33.82mm size is extremely compact, belonging to a mini display module. It can be easily embedded into various volume-restricted devices in smart home environments, and screens of this size with the same specifications usually have a resolution of 128x128 pixels, which is sufficient to meet the basic data and simple interface display requirements of smart home devices.

Adaptability and stability features: These small-sized TFT LCD screens are often paired with mainstream driver ICs such as ST7735 or GC9106, and mostly use 4SPI interfaces. They only require a small number of I/O ports to drive and can be conveniently compatible with common main control platforms like Arduino and STM32, facilitating device integration. At the same time, similar products generally can adapt to working temperatures ranging from -20 to 70 , capable of coping with temperature changes in different areas of the home environment, ensuring stable operation. Some products also have anti-static characteristics, further enhancing the reliability of use. Additionally, it usually uses 3.3V low voltage power supply, with low power consumption, meeting the energy-saving and battery life requirements of smart home devices.

Applications in the smart home field

Smart home control terminal: It can serve as a display component for small wall control panels or smart switches, used to display light brightness levels, the type of currently controlled devices, scene mode icons, etc. For example, on a lighting control panel, different colors and icons can be used to distinguish between meeting, sleeping, etc. modes, allowing users to intuitively view the current status and operate to switch.

Environmental monitoring equipment: Suitable for small household temperature and humidity meters, air quality detectors, etc. 262K colors can be used to identify environmental conditions through different colors, such as displaying green when air quality is excellent, yellow when there is mild pollution, etc. It can clearly display specific temperature and humidity values, PM2.5 concentration, etc., allowing users to quickly grasp the home environment situation.

Security and sensing equipment: Devices like door sensors, human body sensing alarms, etc. can be equipped with this screen. When the door is opened abnormally, the screen can pop up an alarm icon and display the alarm time; it can also display basic information such as the battery level of the smart door lock and the number of unlock attempts in the auxiliary display area of the smart door lock, assisting users in understanding the device's operation status.

Small household appliances auxiliary display: Can be used for mini smart appliances, such as small intelligent humidifiers, desktop purifiers, etc. It is used to display the working mode of the device, water level reminder, running time, etc. For example, when the humidifier is out of water, the screen uses specific colors and text to remind the user to add water, enhancing the interactivity of the product.

Technical Specifications

Product Name	Small TFT Lcd Display 1.44 inch With MCU Interface Lcd Module
Display Outline Size	30.05 * 33.82 mm * 2.3 T
Surface Treatment	Glare
Number of color	262K
Viewing Angle	12 O ' Clock
Technology Type	a-Si TFT
Pixel Configuration	R.G.B. Vertical Stripe
Interface Type	MCU 8 Bits
Controller / Driver	ST7735S

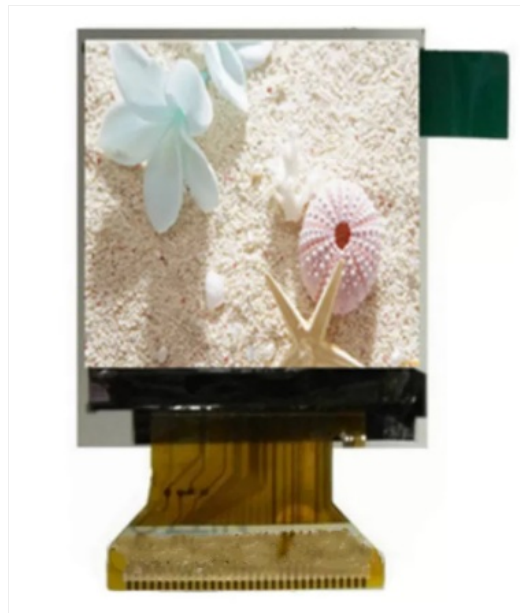
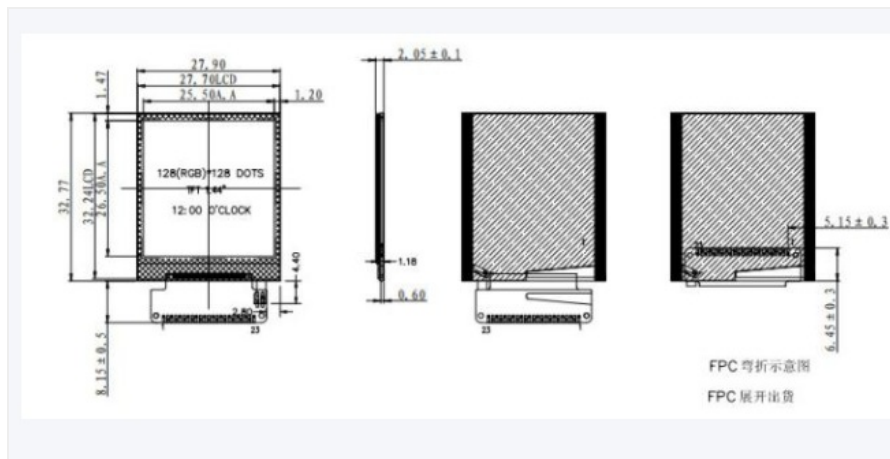

NO.	PIN NAME	I/O	Description
1	YD	NC	NC
2	XL	NC	NC
3	YU	NC	NC
4	XR	NC	NC
5	IOVCC	P	Power Supply1.8V Voltage
6	GND	P	Power ground
7	VDD	P	Power Supply2.8V Voltage
8	DB7	I/O	Display Data I/O
9	DB6	I/O	Display Data I/O
10	DB5	I/O	Display Data I/O
11	DB4	I/O	Display Data I/O
12	DB3	I/O	Display Data I/O
13	DB2	I/O	Display Data I/O
14	DB1	I/O	Display Data I/O
15	DB0	I/O	Display Data I/O
16	/RD	P	Read strobe signal input pin
17	/WR	I	Write strobe signal input pin
18	RS	I	Register select signal
19	/RESET	I	LCM Reset input signal
20	/CS	I	Input pin for chip selection signal
21	BL-K	I	LED Cathode
22	BL-K	I	LED Cathode
23	BL-A	I	LED Anode

Frequently Asked Questions

I want the LCD display 8 digits and the outline size is 65x30x2.8mm?

No problem. Firstly, please kindly send us your specification/drawing paper. If you have not the specification, you can also provide your samples; we will recommend the suitable one if it is standard products. Or we can customize for you based on your own requirement.

This LCD is just what we want, but it is big size, do you have any smaller size? And the display content need to be changed a little.

For the segment type LCD module, if you need modify the outline size or display content, a new LCD glass module is need. We have to open new tooling for you.

This LCD display is HTN type, but I want STN type, can you make?

That's all right. We can change for you as per you request.

I want customize a new LCD module. Can you do?

Yes, we can. Please send your drawing paper. If you have not, please advise me the outline size of the LCD display, display information (Glass thickness, Polarizer, Display Type, Connector mode, Storage Temp. Operating Temp. Supply Voltage, Viewing direction, drive condition), we can customize for you.

What is leading time for tooling?

General speaking, it will cost 15 to 25 days after drawing paper confirmation and tooling charge payment, we can report you the exact time when you confirm the drawing paper.

Can you send us samples for checking?

Yes. Samples order is available.

What is the Leading Time?

If we have stock for the standard ones, the leading time is one day after payment. If it is the mass production for special ones, the leading time is about 15-30 days. Suppose we can finish earlier, we will report the information in advanced.



Dongguan Bibuke Electronic Technology Co., Ltd.



+8613711912723



Jack@smartwinlcd.cn



lcdtftscreen.com

Shangyu Commercial Centre Chang'an, Dongguan, Guangdong, China 523881