

## 4.3-Inch 480x272 Resistive Touch IPS TFT LCD Display with All Viewing Angles

Our Product Introduction

for more products please visit us on [lcdtftscreen.com](http://lcdtftscreen.com)

### Basic Information



### Product Specification

- Color Gamut: RGB
- Pin Number: 40 PIN
- Surface Luminance: 500 Cd/m<sup>2</sup>
- Connect: ZIF FPC 46mm
- Screen Type: TFT
- Lcd Type: IPS
- Operating Temp: -20 To +70
- Size: 4.3 Inches
- Highlight: **4.3-Inch TFT LCD Display ,  
480x272 Resolution IPS TFT LCD ,  
IPS All Viewing Angles Resistive Touch Screen**



### 4.3-Inch 480x272 Resistive Touch IPS TFT LCD Display

#### Technical Specifications

Product	4.3 Inch Resistive Touchscreen TFT
Resolution	480x272
Surface Luminance	500 Cd/m <sup>2</sup> (nits)
Viewing Direction	IPS, All Viewing Angles
Interface	RGB
Driver IC	ST7283
Pin Number	40 Pins
Touch Screen	Resistive Touch Panel (RTP)
Connection	ZIF FPC 46mm
Operating Voltage	3.3V
Operating Temperature	-20°C to +70°C
Storage Temperature	-30°C to +80°C
LED Lifetime	40,000 Hours

#### Product Overview

This 4.3-inch resistive touch IPS TFT LCD module offers a practical and compatible small-sized display solution. The compact 4.3-inch design is ideal for portable devices, providing clear display of operation interfaces and data information without occupying excessive space.

#### Key Features

- 480×272 WQVGA resolution with moderate pixel density
- IPS technology for full-view display with minimal color deviation
- Four-wire resistive touch screen compatible with fingers, gloves, and stylus
- Resistant to oil, dust, and wear for industrial environments
- RGB parallel interface for easy MCU/MPU integration
- Wide temperature operating range (-20°C to 70°C)
- Low power consumption suitable for battery-powered devices
- Cost-effective solution for mid-range embedded display projects

#### Applications

- Industrial Control:** HMI for frequency converters, PLC control panels, textile machinery, packaging equipment, and intelligent instruments
- Vehicle & Transportation:** Navigation systems, instrument panels, monitoring terminals, and bus card readers
- Portable Terminals:** Handheld POS machines, logistics scanners, medical testing instruments, and data collectors
- Smart Home & Appliances:** Charging stations, air conditioning controllers, smart home gateways, and vending machines
- Security & IoT:** Access control systems, intercom units, and network camera displays



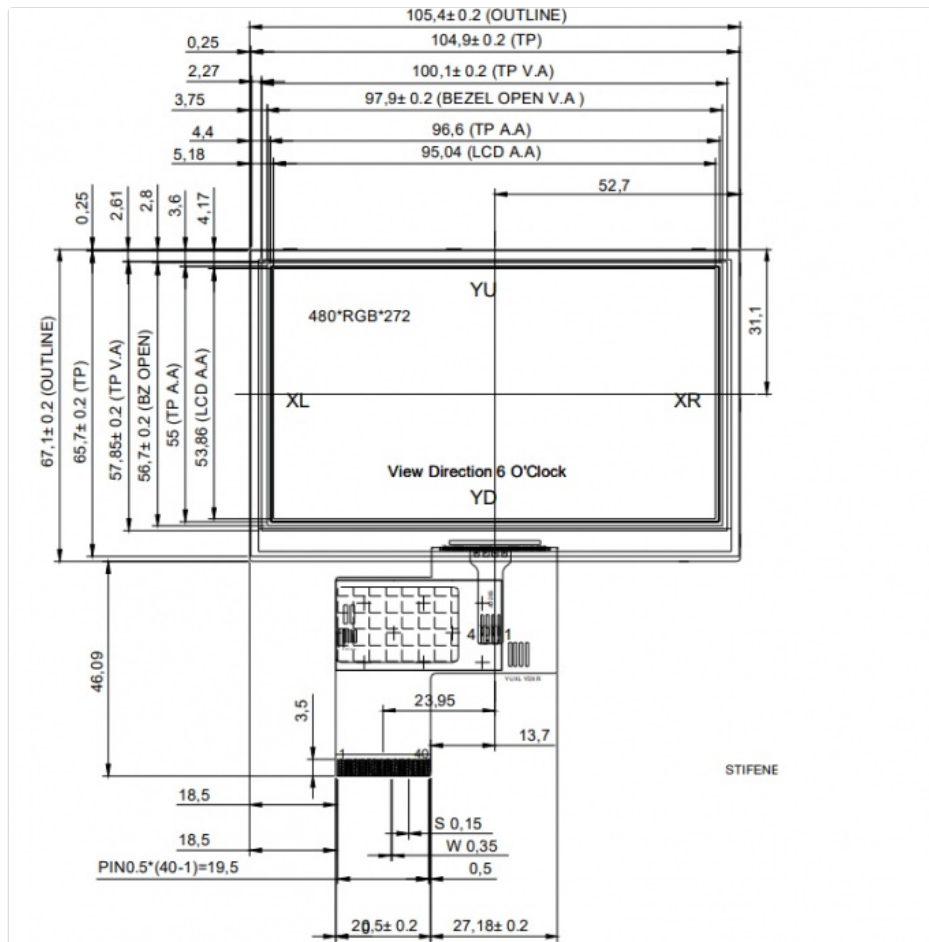

## Frequently Asked Questions

### I want the LCD display 8 digits and the outline size is 65x30x2.8mm. Is this possible?

Yes, we can accommodate custom specifications. Please provide your detailed specifications or drawing. If unavailable, send samples and we'll recommend suitable standard products or customize based on your requirements.

### This LCD is what we want, but it's too large. Do you have smaller sizes with modified display content?

For segment type LCD modules requiring size or content modifications, new LCD glass modules with custom tooling are necessary.

### This LCD display is HTN type, but I want STN type. Can you make this change?

Yes, we can modify the display type according to your specifications.

### Can you customize a new LCD module?

Yes, we provide full customization services. Please provide your drawing or specifications including outline size, display information, glass thickness, polarizer, display type, connector mode, temperature ranges, voltage requirements, viewing direction, and drive conditions.

### What is the lead time for tooling?

Typically 15-25 days after drawing confirmation and tooling payment. Exact timing will be confirmed upon drawing approval.

### Can you send samples for evaluation?

Yes, sample orders are available for standard products.

### What is the production lead time?

Standard products in stock ship within one day after payment. Mass production for custom orders typically takes 15-30 days, with earlier completion communicated in advance.



**Dongguan Bibuke Electronic Technology Co., Ltd.**



+8613711912723



Jack@smartwinlcd.cn



lcdtftscreen.com

Shangyu Commercial Centre Chang'an, Dongguan, Guangdong, China 523881