

4 inch 480x800 Medical TFT LCD Display with Resistive Touch Panel and RGB Interface

Our Product Introduction

Basic Information

- Place of Origin: China
- Brand Name: BBI
- Certification: ISO9001 RoHS
- Minimum Order Quantity: 1000
- Price: 0.7-7USD
- Packaging Details: CARTON
- Delivery Time: 3-4WEEKS
- Payment Terms: T/T
- Supply Ability: 100000/MONTH



Product Specification

- Viewing Direction: 12 O'clock
- Pin Number: 51 Pins
- Touch Screen: Resistive Touch Panel (RTP)
- Connect: Plugging
- Surface Luminance: 300 Cd/m² (nits)
- Driver IC: ILI9806E
- Screen Size: 4 Inches
- Technology: LCD
- Highlight: 4 inch medical TFT LCD display , 480x800 resistive touch screen, RGB interface TFT LCD panel



for more products please visit us on lcdtftscreen.com

Product Description

4 inch 480x800 Medical TFT Display RGB Interface LCD Touch Screen

4 inch 480x800 Medical TFT Display RGB Interface LCD Touch Screen

Product Specifications

Product:	4"inch TFT LCD Touch Screen	Touch Screen:	Resistive Touch Panel (RTP)
Resolution:	480x800	Viewing Direction:	12 O'clock
Driver IC:	ILI9806E	Pin Number:	51 Pins
Connection:	Plugging	Surface Luminance:	300 Cd/m2 (nits)
Interface:	RGB	LED Lifetime:	40,000 Hours
Operating Temp.:	-20 To +70	Compliance:	REACH & RoHS Compliant

Product Introduction

This is a 4-inch, 480×800 resolution medical-grade TFT liquid crystal touch screen, featuring a high-speed RGB interface + IPS full-view display, combined with capacitive touch control. It is specifically designed for medical equipment to meet the requirements of high precision, high reliability and a clean environment.

Display Core (Medical-grade TFT/IPS)

Size: 4 inches (vertical screen, elongated aspect ratio)

Resolution: 480×800, high pixel density, clear text / curves

Panel: IPS full viewing angle, ≥ 85° up, down, left, and right, suitable for multi-person consultation viewing

Color: 16.7M colors (24-bit), accurately reproduces medical images and parameters

Brightness: 400-600 cd/m², clear visibility in operating room strong light

Contrast: 800:1-1000:1, good gray level, suitable for waveform / electrocardiogram display

Backlight: WLED, lifespan ≥ 50,000 hours, low blue light, no flicker

Surface: Anti-glare + antibacterial coating, easy to clean, resistant to alcohol / iodophor wiping, in line with medical infection control

Thickness: Approximately 2.0-2.8 mm, ultra-thin and lightweight, suitable for portable devices

Interface and Driver (RGB + Capacitive Touch)

Interface: 24-bit RGB parallel, high-speed transmission, no ghosting, suitable for dynamic waveforms

Driver IC: Common ST7701S, NT35510, medical-grade low power consumption, anti-interference

Touch: Projective capacitive (PCAP), supports multi-touch (such as zooming images)

Touch IC: GT911/FT6336, fast response, high precision, supports operation with medical gloves

Operating temperature: -20°C to + 70°C, stable adaptation to low/high temperature disinfection environments

Protection: ESD anti-static, EMI anti-interference, in line with medical equipment electromagnetic compatibility standards

Main Applications

Medical monitoring equipment: Multi-parameter monitor, electrocardiogram / blood oxygen / blood pressure monitor, displays real-time waveforms, values, and alarm information, IPS wide viewing angle suitable for bedside and nurse station observation

Portable medical instruments: Handheld ultrasound, fundus camera, blood glucose meter, electrocardiogram machine, high resolution clearly presents fine images and data, ultra-thin design is convenient for carrying

Operating room equipment: Anesthesia machine, ventilator, infusion pump, endoscopy system, strong light visibility + antibacterial surface, meets aseptic operation and precise control requirements

Medical terminals and panels: Hospital bed head terminal, medical control panel, self-service registration / inquiry machine, vertical screen ratio suitable for information lists and operation interfaces

Home medical health equipment: Smart health monitor, rehabilitation training equipment, remote medical terminal, low blue light eye protection, suitable for long-term use

Product Drawings

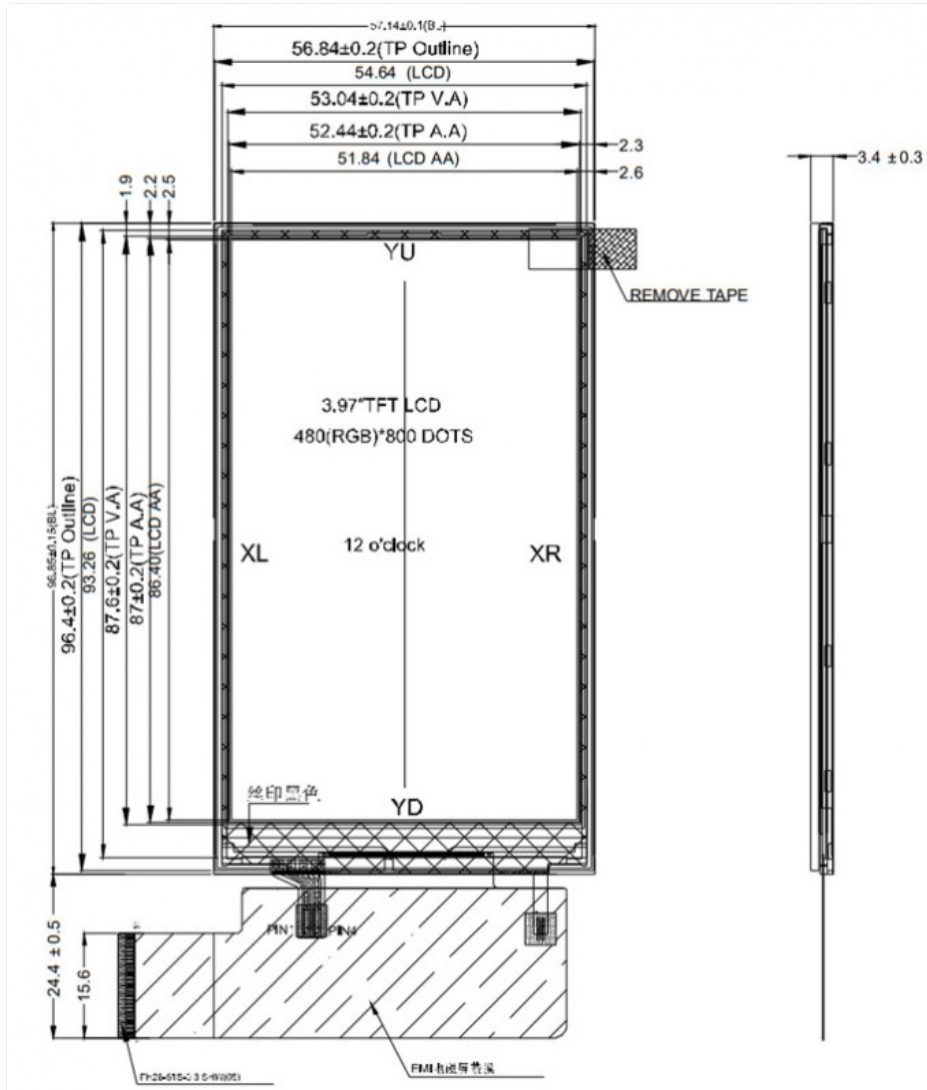

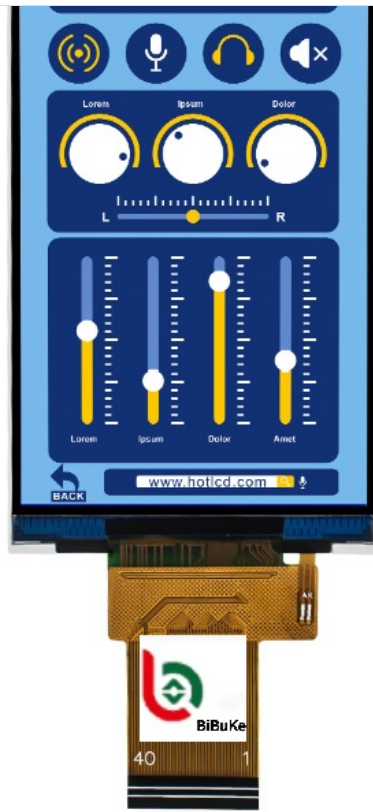

Frequently Asked Questions

1. I want the LCD display 8 digits and the outline size is 65x30x2.8mm.....?

Answer: No problem. Firstly, please kindly send us your specification/ drawing paper. If you have not the specification, you can also provide your samples; we will recommend the suitable one if it is standard products. Or we can customize for you based on your own requirement.

2. This LCD is just what we want, but it is big size, do you have any smaller size? And the display content need to be changed a little.

Answer: For the segment type LCD module, if you need modify the outline size or display content, a new LCD glass module is need. We have to open new tooling for you.

3. This LCD display is HTN type, but I want STN type, can you make?

Answer: That's all right. We can change for you as per you request.

4. I want customize a new LCD module. Can you do?

Answer: Yes, we can. Please send your drawing paper. If you have not, please advise me the outline size of the LCD display, display information (Glass thickness, Polarizer, Display Type, Connector mode, Storage Temp. Operating Temp. Supply Voltage, Viewing direction, drive condition), we can customize for you.

5. What is leading time for tooling?

Answer: General speaking, it will cost 15 to 25 days after drawing paper confirmation and tooling charge payment, we can report you the exact time when you confirm the drawing paper.

6. Can you send us samples for checking?

Answer: Yes. Samples order is available.

7. What is the Leading Time?

Answer: If we have stock for the standard ones, the leading time is one day after payment. If it is the mass production for special ones, the leading time is about 15-30 days. Suppose we can finish earlier, we will report the information in advanced.

Our Service

Free repair within one year after the shipment of products from us.

Replacement within 30 days after the shipment of products from us due to products' problems.

We can print your logo and stick your model No. on the cameras.

We have long cooperation with many shipping companies and our export volume is large. The shipping companies can offer us good discounts.

Professional technician supports. We have a good after-sales service team. They can solve your problems in time.

All goods will be inspected and tested by our engineers and QC/QA before packing and shipment.

Customers satisfactory is most important to us. If you have any problem or questions regarding our transaction. Please contact us by Email or online. It will be responded within 24 hours.

Products pictures only for your reference. Please kindly refer to the specification. We can provide the products based on the specification. Or you can offer your own specification or drawing, we can customize all kinds of LCD displays for you. Thanks for your kind support always.



Dongguan Bibuke Electronic Technology Co., Ltd.



+8613711912723



Jack@smartwinlcd.cn



lcdftscreen.com

Shangyu Commercial Centre Chang'an, Dongguan, Guangdong, China 523881